

WAL * MART
 STORE #3868-00
 C-195-SGR-OR
 +/- 219,187 S.F.
 F.F.E. = 168.00

**EXECUTIVE
 DIRECTOR
 APPROVAL**

Date 7/28/19 By [Signature]

OVERALL SITE PLAN

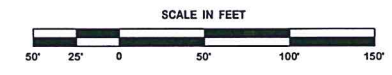
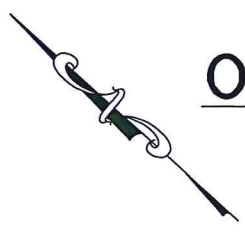

REVISION	BY

DDG
 DUPLANTIS DESIGN GROUP, PC
 THIBODAUX / COVINGTON
 HOUSTON / BATON ROUGE / LOUISIANA
 WWW.DDGPC.COM

STAMP

SIGNATURE _____
 DATE _____

PROPOSED SITE PLAN MODIFICATION
 WAL-MART SUPERCENTER # 3868
 SHREVEPORT, LOUISIANA

DRAWN MTB
CHECKED GRL
ISSUED DATE 6-17-17
ISSUED FOR SITE PLAN REVIEW
PROJECT NO. 17-326
FILE 17-326 C-1 MAP
SHEET C-1

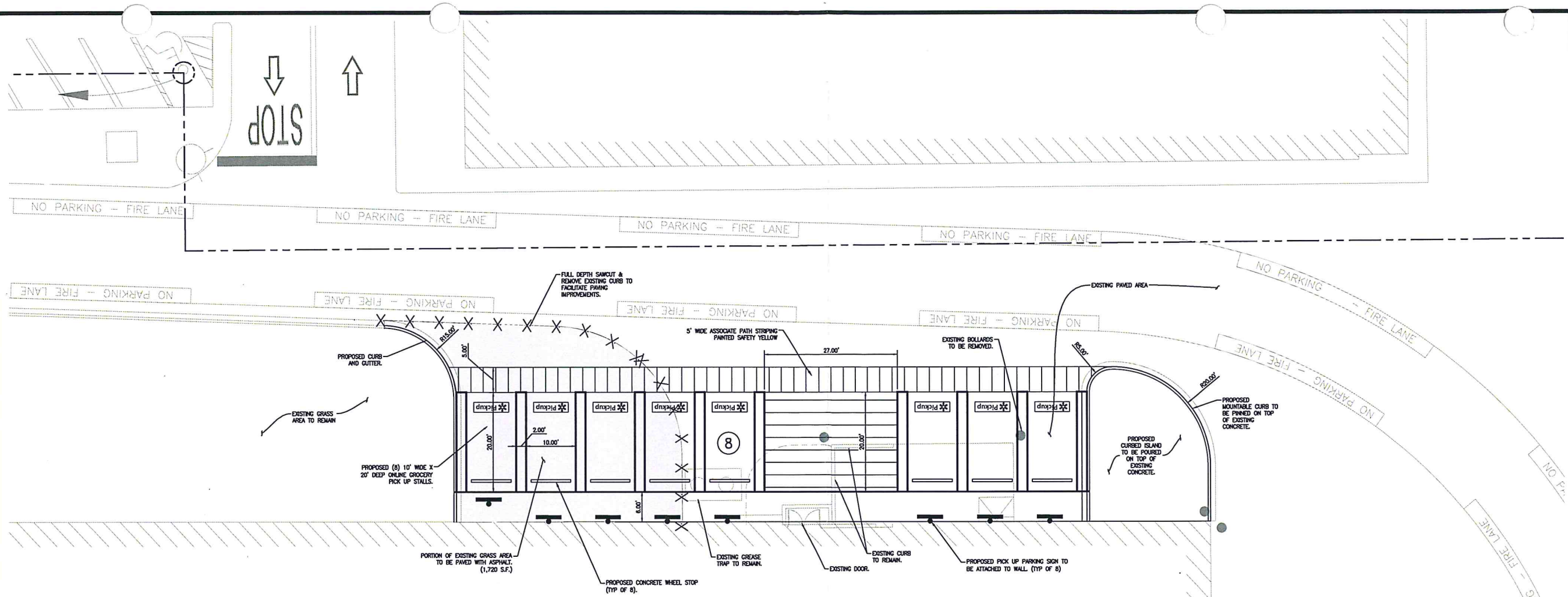

WAL-MART SUPER CENTER

LEGEND FOR REQUIRED IMPROVEMENTS

- 10 PARKING SPACES
- PROPERTY LINE
- GRASS AREA TO BE PAVED WITH ASPHALT

EXECUTIVE
DIRECTOR
APPROVAL

Date 7/28/17 By *My*

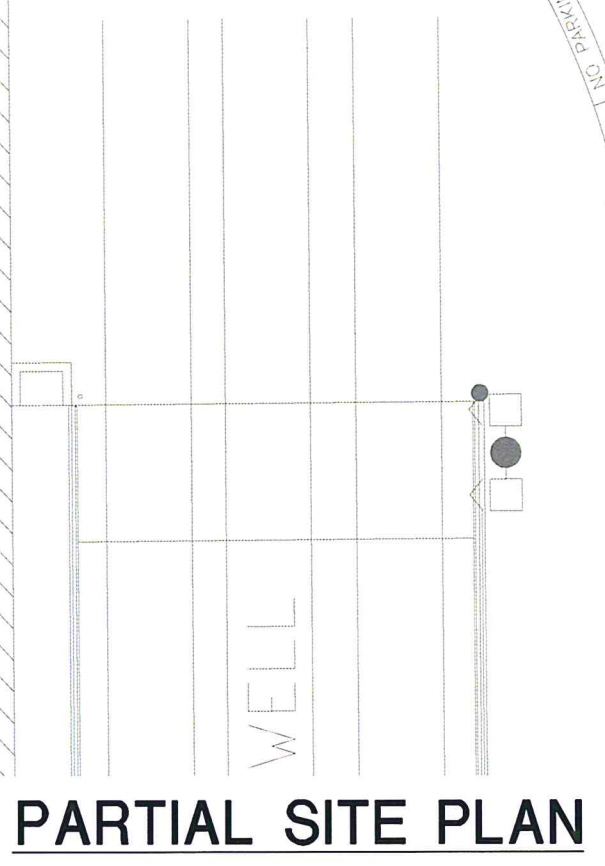

PARTIAL SITE PLAN

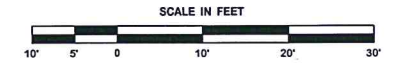

REVISION	BY

DUPLANTIS DESIGN GROUP, PC
 314 E. Bayou Road, Thibodaux, LA 70301
 Phone: 985.447.0090 | Fax: 985.447.7009
 WWW.DDGPC.COM
 THIBODAUX, LOUISIANA
 HOUSTON \ BATON ROUGE \ THOUMA

SIGNATURE _____
DATE _____

STAMP

PROPOSED SITE PLAN MODIFICATION
 WAL-MART SUPERCENTER # 3868
 SHREVEPORT, LOUISIANA

DRAWN	MTB
CHECKED	GRL
ISSUED DATE	6-27-17
ISSUED FOR	SITE PLAN REVIEW
PROJECT NO.	17-326
FILE	17-326 C-3 SITE PLAN
SHEET	C-1.1

J:\CAD\DWG\WAL-MART\2017\17-326\17-326 C-3 SITE PLAN.dwg