

19-454-C

<p><b>Mohr and Associates, Inc.</b>  <i>Consulting Civil Engineers &amp; Land Surveyors</i>                  1324 N. Hearne Ave., Ste 301 Phone : (318) 686-7190                  Shreveport, Louisiana 71107 Fax : (318) 402-4400</p>	FOR: <b>Gene Nims Builders</b> Conceptual Driveway Layout Christus Schumpert Highland Hospital Bert Kouns Industrial Loop/LA Hwy 526	Date Nov. 5, 2019 Scale 1"=60' Drawn RWL Job 37154

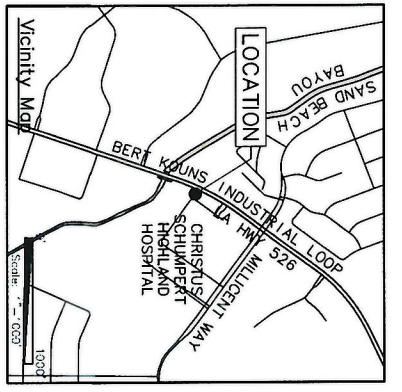

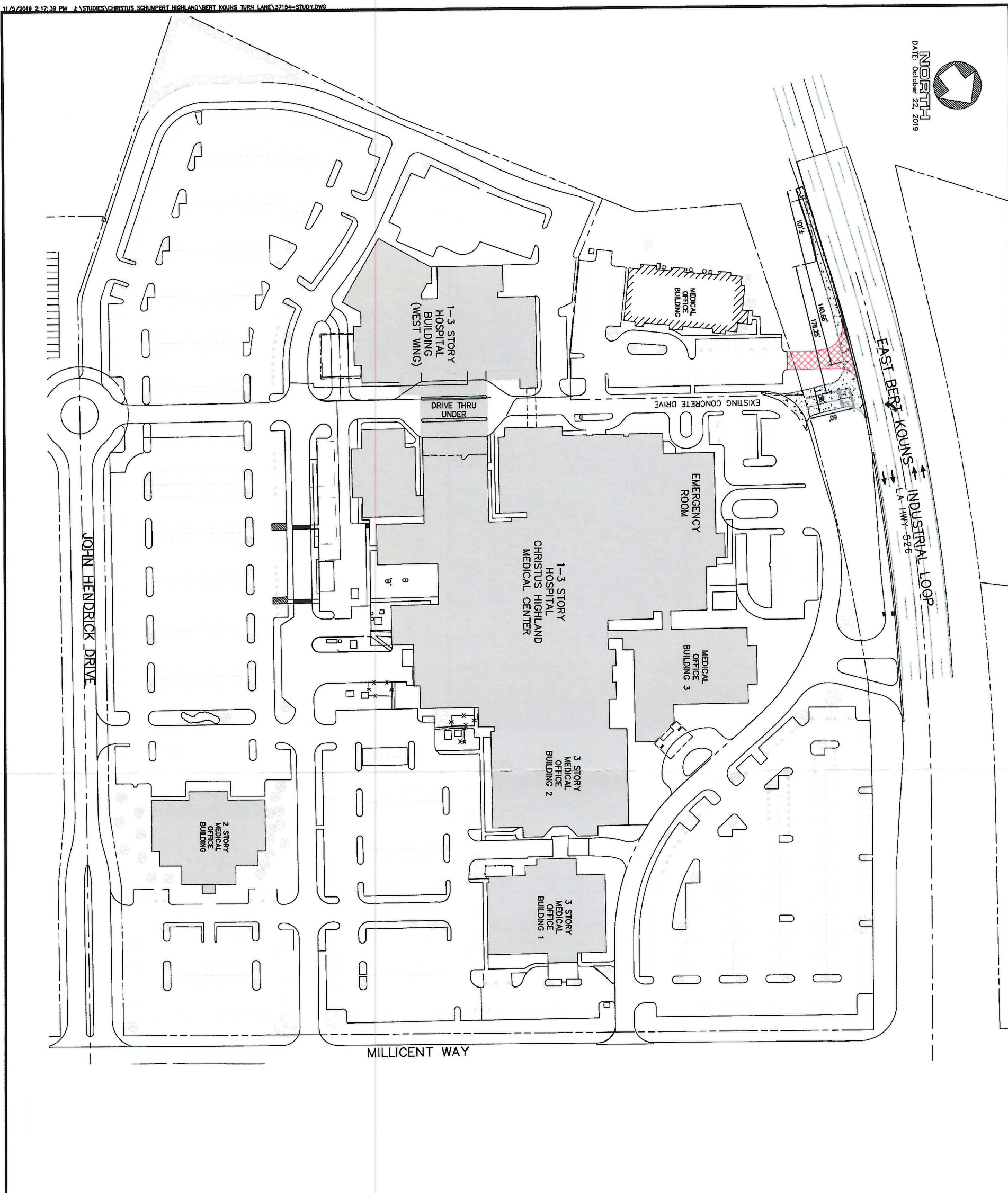

**ISLAND LEGEND**

- TREE
  - SHRUBS
- NOTE: ALL OTHER ISLANDS ARE GRASS UNLESS SHOWN OTHERWISE.

APPROVED: \_\_\_\_\_  
MPC Executive Director Date

**CHRISTUS HEALTH NORTH LOUISIANA**  
ATTN: PROPERTY TAX  
IRVING, TX 75038

NOTE: THIS IS NOT A BOUNDARY SURVEY AND DOES NOT CONFORM TO THE LOUISIANA "STANDARDS OF PRACTICE" FOR A PROPERTY BOUNDARY SURVEY. ALL BOUNDARY COURSES ARE BASED ON THE PLAT RECORDED IN BOOK 3000, PAGE 171.

LOT 1, CHRISTUS-SCHUMPERT COMMERCIAL SUBDIVISION UNIT NO. 1, BK. 3000, PG. 171, CONVEYANCE RECORDS OF CADDO PARISH, LA. 25,661 ACRES

19-454-C

<p><b>DRIVEWAY RELOCATION</b> <b>CHRISTUS HIGHLAND</b> <b>1449 EAST BERT KOUNS INDUSTRIAL LOOP</b> CHRISTUS SHREVEPORT-BOSSIER HEALTH SYSTEM HIGHLAND</p>	<p><b>Mohr and Associates, Inc.</b> <i>Consulting Civil Engineers &amp; Land Surveyors</i> 1324 N. Hearne Ave., Ste 301 Phone : (318) 686-7190 Shreveport, Louisiana 71107 Fax : (318) 402-4400</p>	<table border="1" style="width: 100%; border-collapse: collapse;"> <thead> <tr> <th style="width: 10%;">NO.</th> <th style="width: 60%;">REVISIONS</th> <th style="width: 30%;">DATE</th> </tr> </thead> <tbody> <tr> <td> </td> <td> </td> <td> </td> </tr> <tr> <td> </td> <td> </td> <td> </td> </tr> </tbody> </table>	NO.	REVISIONS	DATE						
NO.	REVISIONS	DATE									
<p>Drawn: VEG Job: 37435 Sheet: <b>2</b> Date: November 4, 2019 Scale: 1"=60'</p>											