

	NO.	DATE
	103-10003	6/8/15
PROJECT NAME: STREET CREATIONS PROJECT ADDRESS: 103-10003 PROJECT CITY: NEW ORLEANS, LA 70113		
ARCHITECT: MASCHA FARRELL ARCHITECT ADDRESS: 205 MILAM ST. SHREVEPORT, LA 71101 PHONE: 337-424-1205		

STREET CREATIONS, DRUG STORE

COMPARISON TO 103-10003 AS CLASSIFIED, RECONSTRUCT, AND REPAIR TO MEET 2015 I.C.C. BUILDING CODE, BUILDING CODE, INDOOR AIR QUALITY, FIELD CREATION, 11' (3' CLEARANCE) UPWARD FROM FLOOR, 20' (2' TO 10' HORIZONTAL) ABOVE FROM FLOOR, 11' (3' CLEARANCE) ABOVE FROM FLOOR, 11' (3' CLEARANCE) ABOVE FROM FLOOR, 11' (3' CLEARANCE) ABOVE FROM FLOOR.

CALL OUTS CALLS AND INSTALLATION: ALL WORK SHALL BE INSTALLED IN ACCORDANCE WITH ALL CITY, STATE, AND FEDERAL REQUIREMENTS AND ALL APPLICABLE CODES AND REGULATIONS.

GENERAL NOTES:

- 1. ALL DIMENSIONS ARE FIELD DIMENSIONS UNLESS OTHERWISE NOTED.
- 2. ALL DIMENSIONS ARE TO FACE UNLESS OTHERWISE NOTED.
- 3. ALL DIMENSIONS ARE TO FACE UNLESS OTHERWISE NOTED.
- 4. ALL DIMENSIONS ARE TO FACE UNLESS OTHERWISE NOTED.
- 5. ALL DIMENSIONS ARE TO FACE UNLESS OTHERWISE NOTED.
- 6. ALL DIMENSIONS ARE TO FACE UNLESS OTHERWISE NOTED.
- 7. ALL DIMENSIONS ARE TO FACE UNLESS OTHERWISE NOTED.
- 8. ALL DIMENSIONS ARE TO FACE UNLESS OTHERWISE NOTED.
- 9. ALL DIMENSIONS ARE TO FACE UNLESS OTHERWISE NOTED.
- 10. ALL DIMENSIONS ARE TO FACE UNLESS OTHERWISE NOTED.
- 11. ALL DIMENSIONS ARE TO FACE UNLESS OTHERWISE NOTED.
- 12. ALL DIMENSIONS ARE TO FACE UNLESS OTHERWISE NOTED.
- 13. ALL DIMENSIONS ARE TO FACE UNLESS OTHERWISE NOTED.
- 14. ALL DIMENSIONS ARE TO FACE UNLESS OTHERWISE NOTED.
- 15. ALL DIMENSIONS ARE TO FACE UNLESS OTHERWISE NOTED.
- 16. ALL DIMENSIONS ARE TO FACE UNLESS OTHERWISE NOTED.
- 17. ALL DIMENSIONS ARE TO FACE UNLESS OTHERWISE NOTED.
- 18. ALL DIMENSIONS ARE TO FACE UNLESS OTHERWISE NOTED.
- 19. ALL DIMENSIONS ARE TO FACE UNLESS OTHERWISE NOTED.
- 20. ALL DIMENSIONS ARE TO FACE UNLESS OTHERWISE NOTED.

- LEGEND:**
- 1. ALL DIMENSIONS ARE TO FACE UNLESS OTHERWISE NOTED.
 - 2. ALL DIMENSIONS ARE TO FACE UNLESS OTHERWISE NOTED.
 - 3. ALL DIMENSIONS ARE TO FACE UNLESS OTHERWISE NOTED.
 - 4. ALL DIMENSIONS ARE TO FACE UNLESS OTHERWISE NOTED.
 - 5. ALL DIMENSIONS ARE TO FACE UNLESS OTHERWISE NOTED.
 - 6. ALL DIMENSIONS ARE TO FACE UNLESS OTHERWISE NOTED.
 - 7. ALL DIMENSIONS ARE TO FACE UNLESS OTHERWISE NOTED.
 - 8. ALL DIMENSIONS ARE TO FACE UNLESS OTHERWISE NOTED.
 - 9. ALL DIMENSIONS ARE TO FACE UNLESS OTHERWISE NOTED.
 - 10. ALL DIMENSIONS ARE TO FACE UNLESS OTHERWISE NOTED.
 - 11. ALL DIMENSIONS ARE TO FACE UNLESS OTHERWISE NOTED.
 - 12. ALL DIMENSIONS ARE TO FACE UNLESS OTHERWISE NOTED.
 - 13. ALL DIMENSIONS ARE TO FACE UNLESS OTHERWISE NOTED.
 - 14. ALL DIMENSIONS ARE TO FACE UNLESS OTHERWISE NOTED.
 - 15. ALL DIMENSIONS ARE TO FACE UNLESS OTHERWISE NOTED.
 - 16. ALL DIMENSIONS ARE TO FACE UNLESS OTHERWISE NOTED.
 - 17. ALL DIMENSIONS ARE TO FACE UNLESS OTHERWISE NOTED.
 - 18. ALL DIMENSIONS ARE TO FACE UNLESS OTHERWISE NOTED.
 - 19. ALL DIMENSIONS ARE TO FACE UNLESS OTHERWISE NOTED.
 - 20. ALL DIMENSIONS ARE TO FACE UNLESS OTHERWISE NOTED.

STREET CREATIONS Site Plan
SCALE: 1/2" = 1'-0"

A1

19-345-C

MPC APPROVED

7/10/19
Date

ae
By

Description of Real Estate

BAC-30-13

19-345-C

Building Sketch

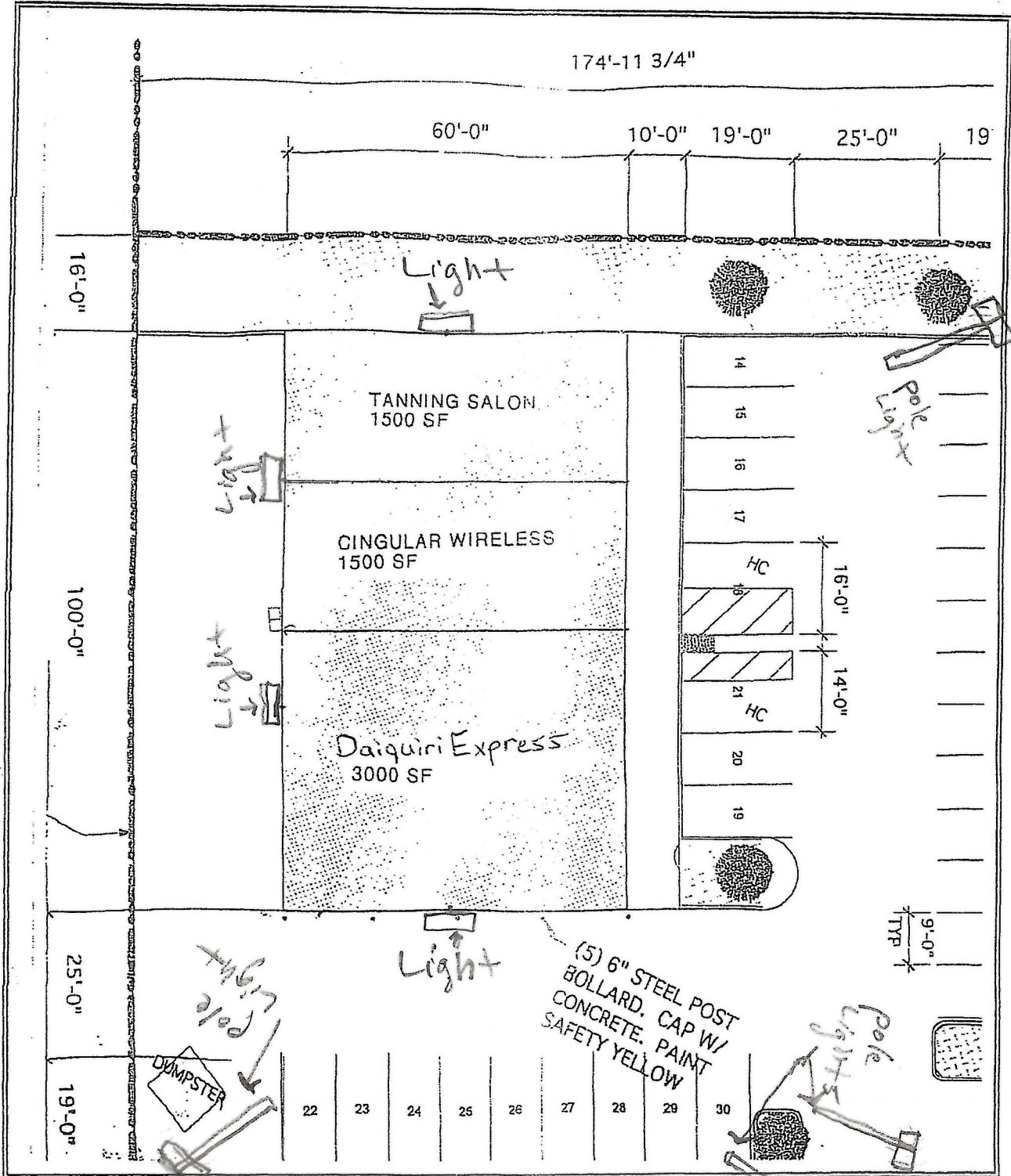

MPC APPROVED

Description of Real Estate

7/10/19
Date

ac
By

19-345-C

Hours of Operation

Monday-Thursday 11 a.m. to 1 a.m.

Friday & Saturday 11 a.m. to 2 a.m.

Sunday 12 noon to 10 p.m.

MPC APPROVED

7/10/19

Date

ac

By

19-345-C

Security Plan

The current premises have 7 cameras that cover the location from front to back with the ability to record and watch remotely from our cell phones. The addition will also include camera coverage from front to back.

MPC APPROVED

7/10/19 ae
Date By

19-345-C