

APPROXIMATE STREET R.O.W. LINE

CENTERPOINT ENERGY
ELECTRIC METER

CLASSROOMS

FFE-215.08

FFE-215.08

JOINTING LEGEND

- TOOLED SIDEWALK JOINT
- SAW-CUT CONCRETE PAVING JOINT
- ++++ DOWELLED CONCRETE OR SIDEWALK PAVING ISOLATION JOINT
- ===== TWO RUNS OF EMPTY 4" SCH. 40 PVC THIMBLES WITH UNCEMENTED KNOCK ON CAP ON EACH END

NUMBERED NOTE LEGEND

- | NO. | DESCRIPTION |
|-----|--------------------------------------|
| 1 | CONCRETE PAVING |
| 2 | 6" HIGH BARRIER CURB |
| 3 | SIDEWALK WITH RAISED CURB EDGE |
| 4 | TYPE 'A' HANDICAP RAMP |
| 5 | TYPE 'B' HANDICAP RAMP |
| 6 | HANDICAP PARKING SIGN |
| 7 | VAN ACCESSIBLE HANDICAP PARKING SIGN |
| 8 | PRE-CAST CONCRETE WHEEL STOP |

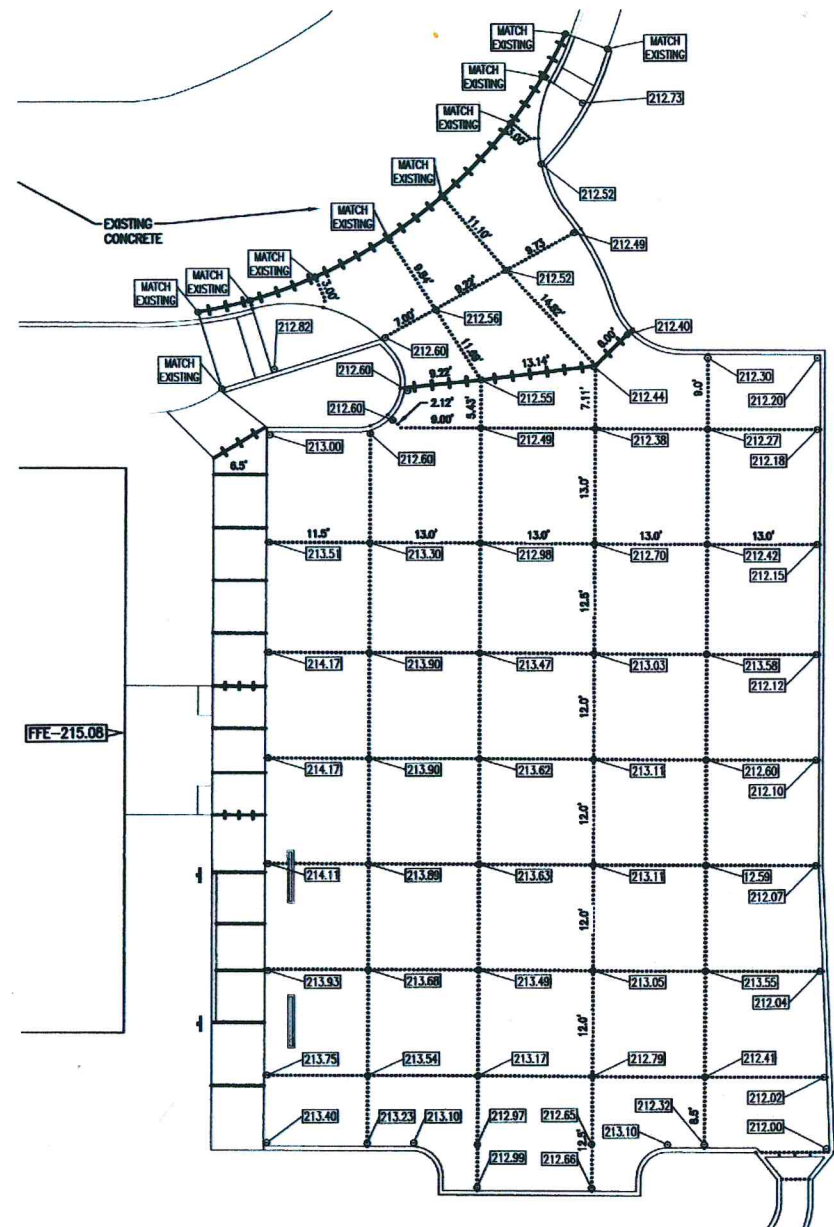

SLAB DIMENSIONS AND ELEVATIONS

EXECUTIVE DIRECTOR APPROVAL

6-30-2020 *W.S.B.*
Date By

DRAWING DISCLAIMER
THIS DRAWING HAS BEEN PREPARED FOR THE CLIENT FOR USE ON THIS PROJECT ONLY. THE DRAWING SHALL NOT BE USED FOR ANY PROJECT OTHER THAN THE ONE SPECIFICALLY LISTED ON THIS DRAWING AND IT SHALL NOT BE USED FOR ANY OTHER PROJECT WITHOUT WRITTEN CONSENT FROM THE PROVIDER. ANY VERSION OF THIS DRAWING WITHOUT AN ENGINEERING SEAL, AFFIXED TO IT WITH A SIGNATURE AND DATE, IS VOID AND SHALL NOT BE USED FOR PLANNING, CONSTRUCTION, OR FOR ANY OTHER OFFICIAL USE.

REVISIONS NO.	DATE	DESCRIPTION

PREPARED FOR:
CADDO PARISH SCHOOL BOARD
1961 MIDWAY AVENUE
HREVEPORT, LA 71130

PROJECT:
NORTH HIGHLANDS PARKING LOT PAVING
PROJECT NO. 2021-239
885 POLEMAN RD.
SHREVEPORT, LA 71107

DRAWING NAME:
PAVING PLAN

PREPARED BY:
ARE CONSULTANTS
PLANNING, DESIGN, & MANAGEMENT PROFESSIONALS
800 Spring Street, Suite 214, Shreveport, LA 71101
www.areconsultants.com
a division of FORD ENGINEERING SERVICES, PLLC



DRAWING SCALE: 1" = 10'
DRAWING DATE: 3/19/2020
DESIGNED BY: W.S.B.
DRAWN BY: W.S.B., S.M.

DRAWING NO.
C3

20-86-C