

PARKING LOT

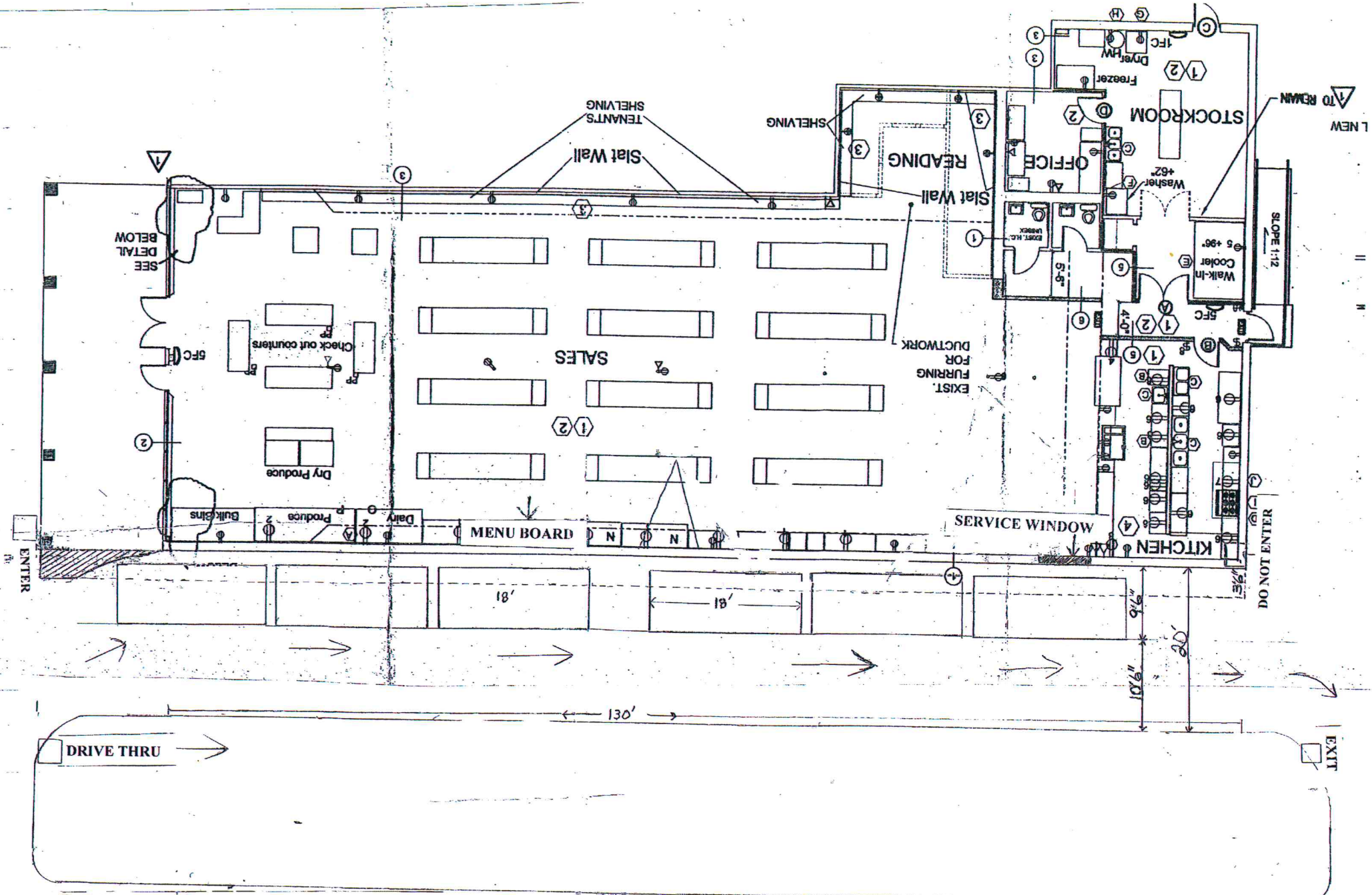

**SOUTHFIELD CENTER
SUNSHINE HEALTH FOODS**
SCALE: 1/8"=1'0"

KAYLA STREET

REMOVE EXISTING SIDEWALK 3'6"
PAVEMENT MARKING: ARROWS INDICATING DIRECTIONS

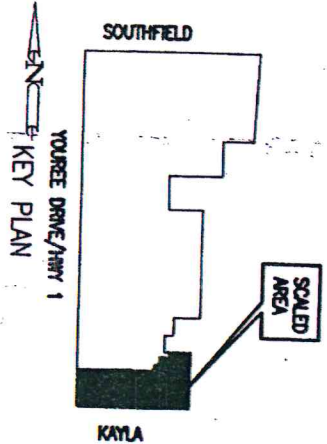

MPC APPROVED
5/6/2020
Date _____ By _____

PROPOSED HEALTHY FOODS

SCALE: 1/8"=1'0"

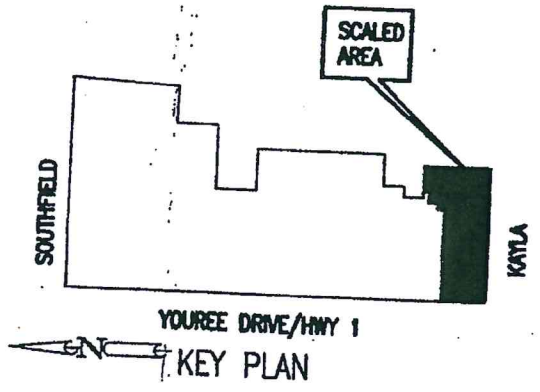

CENTURY A-E of La., INC.
 ARCHITECTS ENGINEERS PLANNERS
 SHREVEPORT, LOUISIANA



JOB NUMBER 48770
 DATE APRIL 11 2020

IA R

MPC APPROVED

5/6/2020
 Date

By

70-33-C