

**Irrigation**  
 1 Backflow  
 Manual Shut-off Valve  
 6 Bubblers around Trees  
 11(4'') Pop-ups  
 5(12'') Pop-ups  
 4(24'') Risers

**Plant Legend**  
 6(30g) Shumard Oak, Quercus Shumardii, 8-10'  
 9(3g) ShiShi Camellia, Camellia Sasanqua Shishi Gashira  
 22(3g) Indian Hawthorn, Raphiolepis Umbellata Minor Yedda  
 4(3g) Red Drift Roses, Rosacea Rosa

**EXECUTIVE  
 DIRECTOR  
 APPROVAL**  
 2/21/18 *[Signature]*  
 Date By

**SCALE: 1/16" = 1'**



A LANDSCAPE PLAN FOR:  
**New Building Addition**  
**Precision Builders**  
**1510 Corporate Drive**  
**Shreveport, LA 71107**

*SITE PLAN*

DRAWN BY: **Scott Crane**  
 DATE: **12-07-17**  
 REVISION:  
 SHEET: **1** OF **1**

CORPORATE DRIVE

LANDSCAPING-  
REFER TO HOOGLAND'S  
LANDSCAPE PLAN  
DATED 12.01.2017.

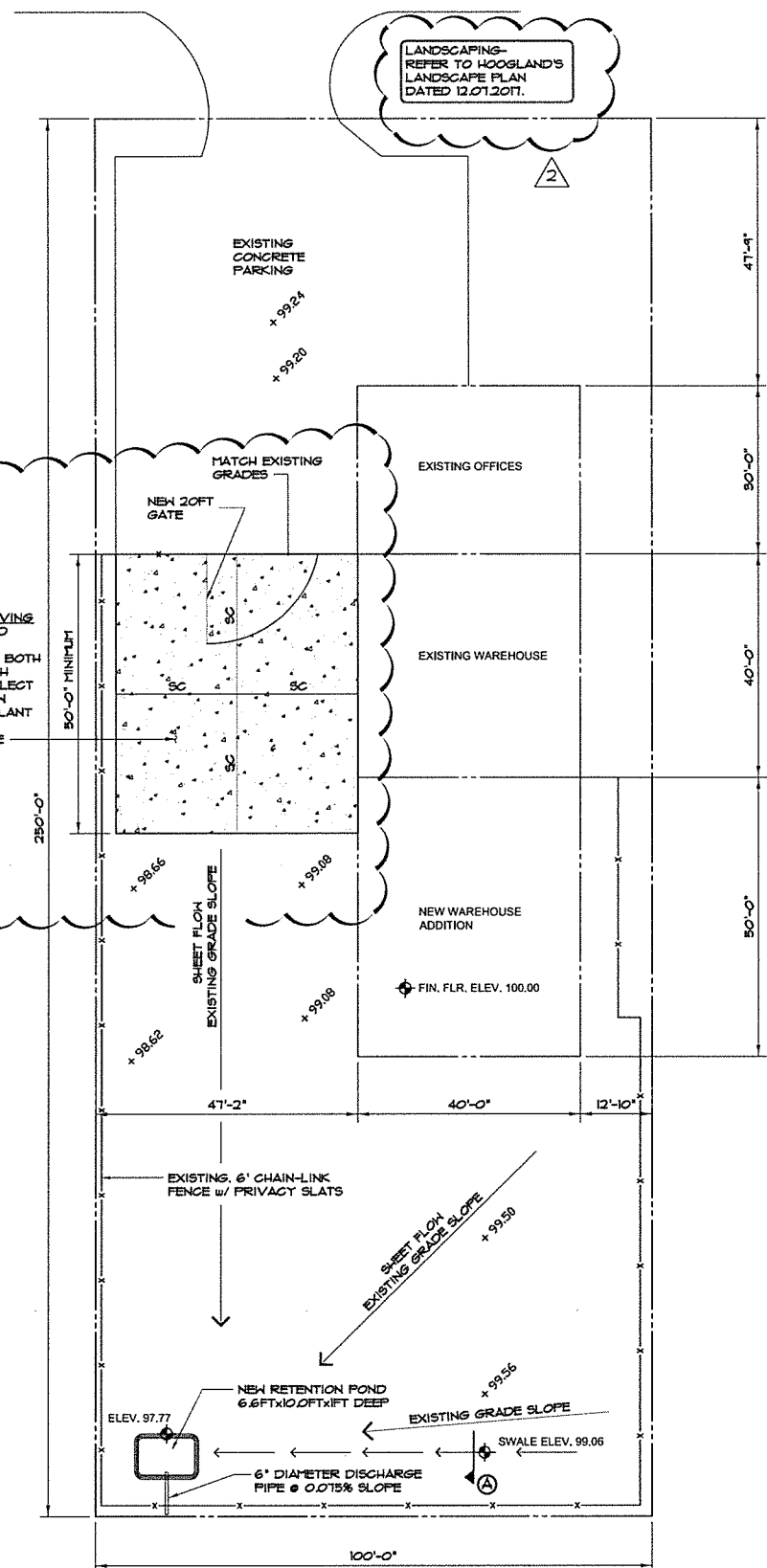

SITE PLAN



12/13/17

PRECISION BUILDERS  
1510 CORPORATE DRIVE  
SHREVEPORT, LA. 71107

DRAINAGE BASIN - TWELVE MILE BAYOU-RED RIVER

TOTAL DEVELOPED AREA - 0.046 ACRES

TOTAL EXISTING STONE AREA - 0.046 ACRES

TOTAL IMPERVIOUS AREA PROPOSED - 0.046 ACRES

EXISTING CONDITIONS ( 10 YEAR STORM)

UNDEVELOPED DISCHARGE

TOTAL AREA - 0.046 ACRES

RUNOFF COEFFICIENT (c) = 0.55

TIME OF CONCENTRATION = 6.4 MINUTES

RAINFALL INTENSITY = 8.5 INCHES/HOUR

DISCHARGE Q = cIA = 0.55\*8.5\*0.046 = 0.21 FT3/SEC

PROPOSED CONDITIONS (25 YEAR STORM)

DEVELOPED DISCHARGE

TOTAL DEVELOPED IMPERVIOUS AREA - 0.046 ACRES

RUNOFF COEFFICIENT (c) = 0.95

TIME OF CONCENTRATION = 3.4 MINUTES

RAINFALL INTENSITY = 9.6 INCHES/HOUR

DISCHARGE Q = cIA = 0.95\*9.6\*0.046 = 0.42 FT3/SEC

\* SOURCE - LA DOTD HYDRAULIC MANUAL

25 YEAR FREQUENCY STORM					
			0.21 FT3/SEC		
RAINFALL DURATION MINUTES	RAINFALL INTENSITY IN/HR *	PEAK RUNOFF RATE CFS	STORM RUNOFF VOLUME CF	RELEASE RATE VOLUME	STORAGE VOLUME CU FT
5	9.0	39	117	64	53
10	7.5	33	195	128	66
15	6.4	28	252	193	59
20	5.6	25	296	258	38
25	5.1	22	331	322	9
30	4.6	20	361	387	-
40	3.9	17	408	516	-
50	3.4	15	445	645	-
60	3.0	13	475	774	-

MAXIMUM RELEASE RATE 0.21 CUBIC FEET/SECOND      MAXIMUM STORAGE VOLUME REQUIRED = 66 FT3

6.6 FEET x 10 FEET x 1.0 FOOT DEEP = 66 CUBIC FEET STORAGE PROVIDED

6" DIAMETER DISCHARGE PIPE @ 0.015% SLOPE DISCHARGE = 0.21 FT3/SEC

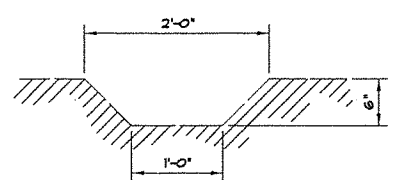

SWALE DETAIL SCALE: N.T.S.

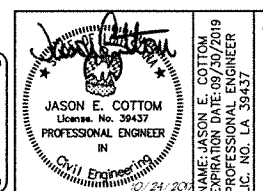
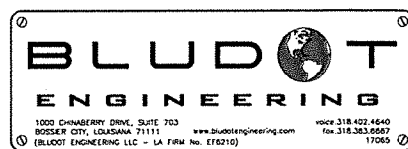

CLIENT  
**PRECISION BUILDERS**  
1510 CORPORATE DRIVE  
SHREVEPORT, LA 71107

SHEET TITLE  
**DRAINAGE PLAN**

PROJECT TITLE  
**WAREHOUSE BUILDING ADDITION**

ISSUED FOR CONSTRUCTION				
NO	REVISION	DATE	PROJECT DATE:	
			10/24/17	
1	REVIEW COMMENTS CORRECTIONS	12/13/17	SCALE:	N/A
2	REVIEW COMMENTS CORRECTIONS	02/20/18		
			DRAWING NO.	C-001