

- PLANT LEGEND**
- ASIAN JASMINE PLANTED TO FILL WITHIN 6 MONTHS
 - BERNALDA GRASS
 - EVERGREEN SHRUBS
 - PURPLE LOPPETALLUM - 10 GAL (4 1/2 ea)
 - AZALEA - 1 GAL (8 1/2 ea)
 - INDIAN HAWTHORN (PINK) - 3 GAL (7 1/2 ea)
 - CREPE MYRTLE - 2" GAL (2 1/2 ea)
 - 2" CAULIPER GINKGO BLOBA

* EXACT PLANT SPECIES, SPACING AND LOCATION TO BE SUBMITTED BY LICENSED LANDSCAPE ARCHITECT WITH LANDSCAPING SUBCONTRACTOR DURING CONSTRUCTION SUBMITTALS PROCESS

** PROVIDE IRRIGATION FOR ALL LANDSCAPING SHOWN IN THIS CONTRACT

PARKING LOT TABLE		SOLID WASTE REQUIREMENTS	
EXISTING PARKING OR PROVIDED	13	ROLLING BIN - NOTED ON PLAN	
REQUIRED	13	GENERAL REQUIREMENTS	
HO ADA	01	ALL ADJACENT ZONING AND LAND USES ARE I-2.	

GRAVEL LOT
OFF LOADING ONLY

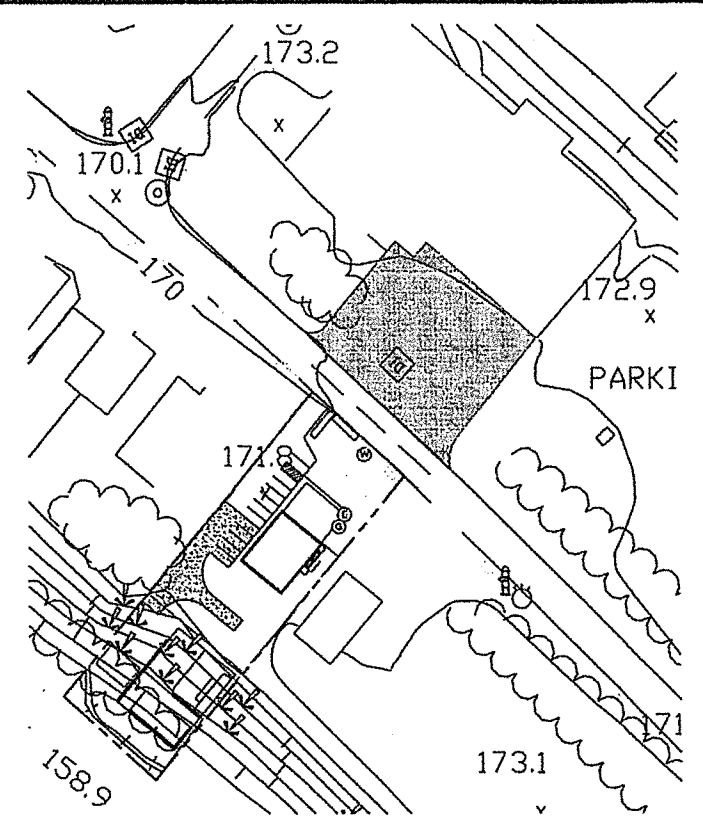
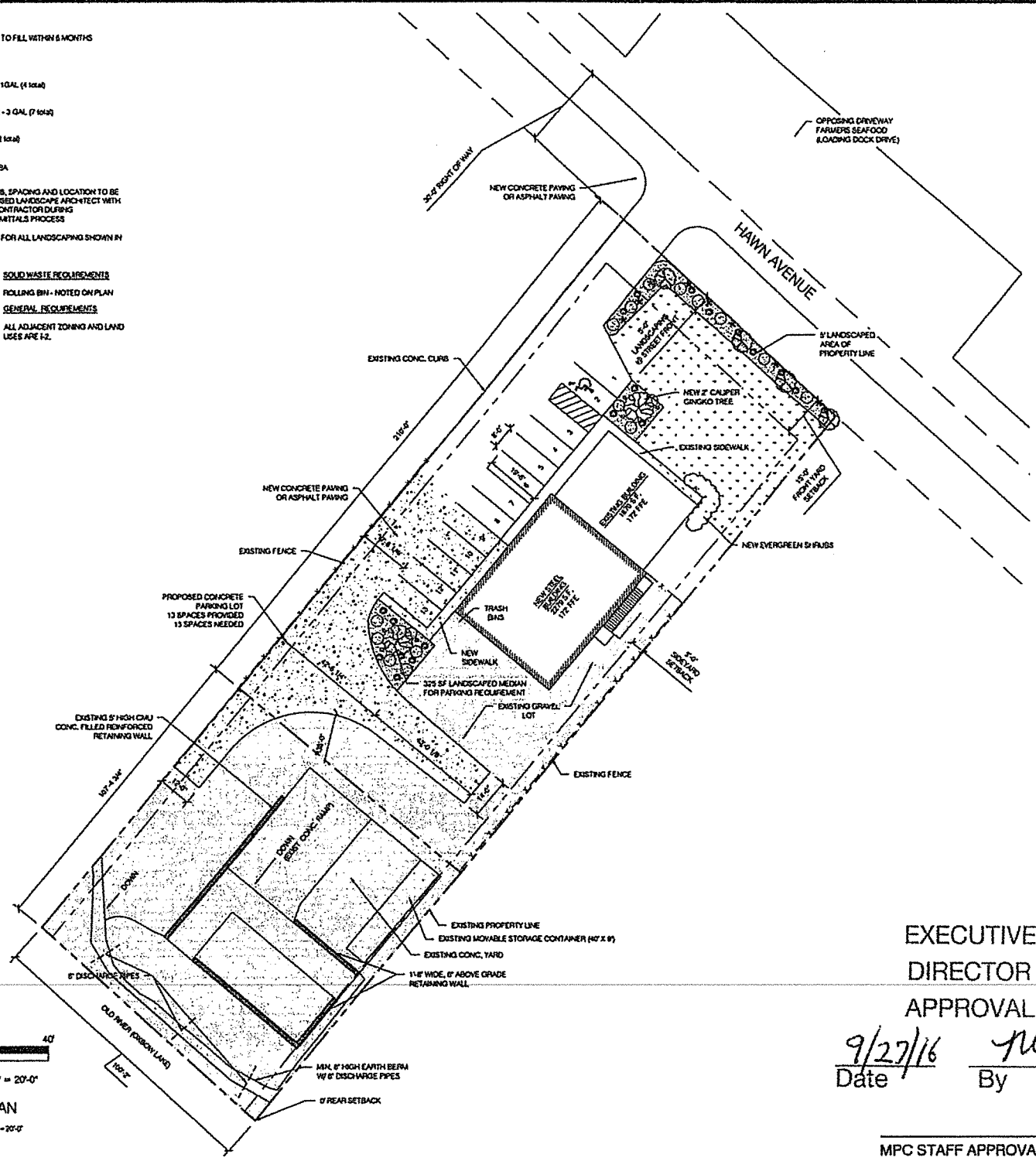
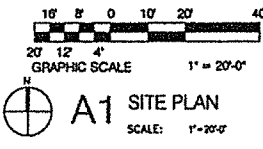

B5 UTILITIES PLAN
SCALE: 1" = 60'-0"

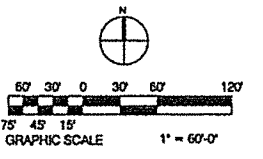

- ⊕ GAS
- ⊕ WATER
- ⊕ ELECTRIC (OVERHEAD)

RECEIVED
SEP 16 2016
Metropolitan Planning Commission

EXECUTIVE DIRECTOR APPROVAL
Date 9/27/16 By [Signature]

MPC STAFF APPROVAL

 IA ARCHITECTURE IARCHITECTURE, LLC JEFF SPIKES 417 LAKE STREET SHREVEPORT, LA 71101 318.828.1637	CURRENT LAND OWNER HALL BUILDERS, INC. RICKEY HALL 1185 HAWN AVE. SHREVEPORT, LA 71107 318-222-4610
	BUSINESS OWNER HALL BUILDERS, INC. RICKEY HALL 1185 HAWN AVE. SHREVEPORT, LA 71107 318-222-4610
SURVEY PROVIDED BY: RALEY & ASSOCIATES 4913 SHED RD BOSSIER CITY, LA 71111 318-752-9023	
FREESTATE IND PK DIST #2 SEE ATTACHED LEGAL DESCRIPTION SHREVEPORT, LA BOSSIER PARISH 31,636 SQ. FT. (0.726 ACRES)	

DATE 09/16/2016